

2025 s/f Single Story Office Bldg

841 S. Cherry, Olathe, KS

Property Status: Active for Lease

Zoning: C-1

Accessibility: Off of Cherry

Property Instructions: 2025 s/f Single Story Office Building built in 2008. Dimensions - 27' x 75'.

Comments: Broker/Agent Bob Montgomery. Terms agreeable to Seller/Lessor.

BOB MONTGOMERY
AGENT/BROKER

Montgomery and Company

107 W. Cedar
Olathe, Kansas 66061

Phone: 913.782.6500

Fax: 913.782.8131

E-mail:

bob@montgomeryandcompany.com

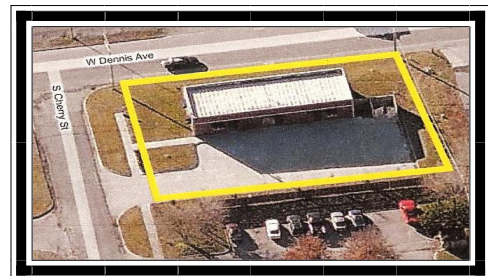

Sale Price

\$219,500.00

Lease Price

\$1500/month

Our clients become our business associates and friends.