

# 5.29 Acres m/l - Maurer Road

*Maurer Road, Shawnee Mission, KS*

**Property Status:** Active for Sale

**Zoning:** Commercial

**Property Size:** 5.29 acres m/l

**Parcel #:** QF241217-1049

**Comments:** Agent Bob Montgomery. Terms agreeable to seller.

**BOB MONTGOMERY**  
AGENT/BROKER

**Montgomery and Company**

107 W. Cedar  
Olathe, Kansas 66061

Phone: 913.782.6500

Fax: 913.782.8131

E-mail:

bob@montgomeryandcompany.com

**Sale Price**

**\$7 s/f**

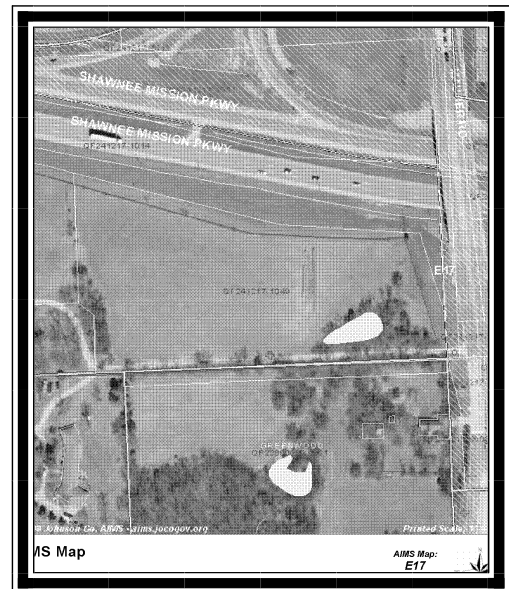
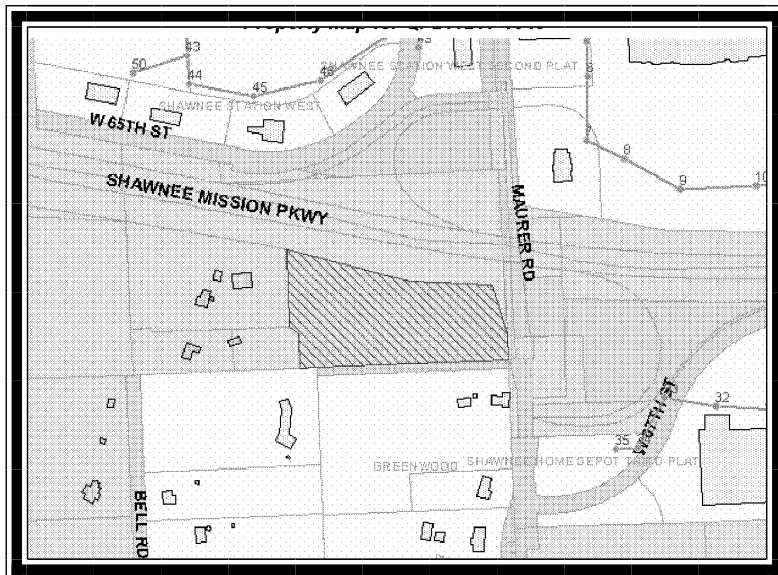

*Our clients become our business associates and friends.*